

The function is to store the liquid refrigerant which supplied to evaporator. Whilst, the liquid receive is capable of storing all the refrigerants in system when maintaining the system. The selection of size of liquid receiver should be based on the refrigerant volume in equipment. The capacity of liquid receiver is listed on the sheet below.

Feature & Advantages

- ◆ Designed for refrigerants storage in system operating or maintaining.
- ◆ System adjustment is allowed to suit with different condition or load.
- ◆ Have both vertical & horizontal design.
- ◆ Option available: sight glass, ball float, valve, bracket, safety valve socket, fusible plug.
- ◆ PTFE sealing gasket.
- ◆ Highly corrosion-resistant powder coating finish. Can be used in all environments, including marine applications.
- ◆ Products are compatible with HFCs, HCFCs, CFCs, as well as with their associated oils and additives.
- ◆ Design and manufacture special receivers according to customers' requirement.

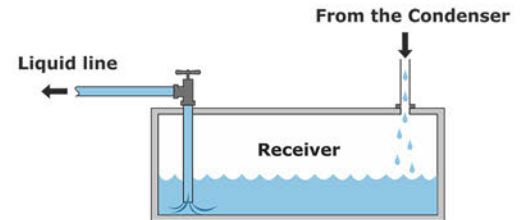
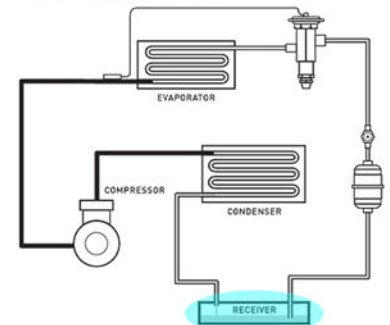

BLR Horizontal Receiver

Applications

- ◆ horizontal receiver needs to be flatly installation to match the best operation.
- ◆ Max. working pressure: 35bar

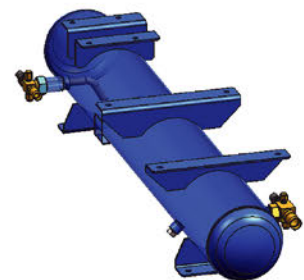
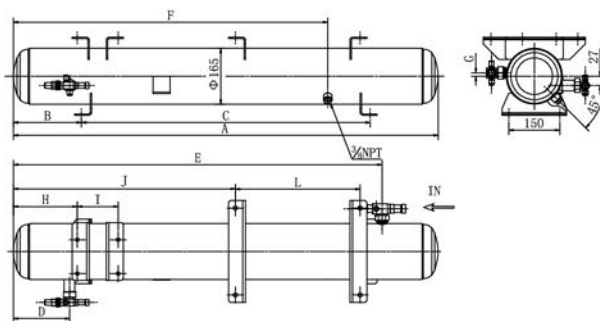

Type	(in) Inlet	(in) outlet	A (mm)	B (mm)	C (mm)	D (mm)	E (mm)	F (mm)	G (mm)	H (mm)	I (mm)	J (mm)	L (mm)	Vol.
BLR -14CL	5/8	1/2	740	170	400	140	600	415	0	-	-	250	293	14.0L
BLR -19CL	7/8	1/2	1014	207	600	122	892	707	10	84	120	520	367	19.3L
BLR -24CLA	7/8	5/8	1250	200	850	165	1085	925	10	188	120	653	367	24.0L
BLR -24CLB	7/8	5/8	1250	200	850	165	1085	925	10	165	120	677	381	24.0L

BLR Horizontal Receiver

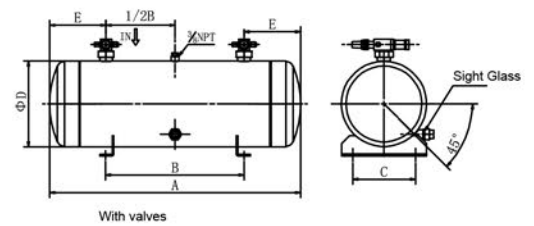
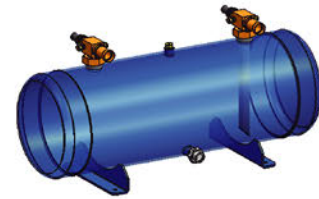
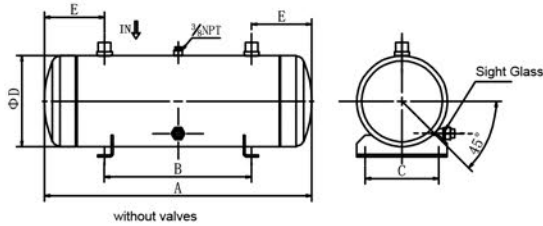

Type	Inlet and outlet (in)	A (mm)	B (mm)	C (mm)	D (mm)	E (mm)	Vol.
30L-V7	7/8	900	600	190	219	150	30L
30L-V9	1-1/8	900	600	190	219	150	30L
30L	1-1/8	900	600	190	219	150	30L
35L-V9	1-1/8	1000	700	190	219	150	35L
35L	1-1/8	1000	700	190	219	150	35L
40L-V9	1-1/8	800	440	220	273	180	40L
40L-V11	1-3/8	800	440	220	273	180	40L
40L	1-3/8	800	440	220	273	180	40L
45L-V11	1-3/8	900	540	220	273	180	45L
45L	1-3/8	900	540	220	273	180	45L
50L-V11	1-3/8	1000	640	220	273	180	50L
50L-V13	1-5/8	1000	640	220	273	180	50L
50L	1-5/8	1000	640	220	273	180	50L
55L-V13	1-5/8	1100	740	220	273	180	55L
55L	1-5/8	1100	740	220	273	180	55L
60L-V11	1-3/8	1200	840	220	273	180	60L
60L-V13	1-5/8	1200	840	220	273	180	60L
60L-V17	2-1/8	1200	840	220	273	180	60L
60L	2-1/8	1200	840	220	273	180	60L

1) Part number with "V" means the inlet/outlet tube with valve.

2) Connection size and volume can be made according to customers' requirement.

BLR Vertical Receiver

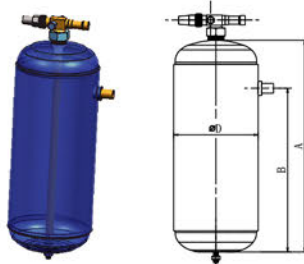

Type	ODF	A (mm)	B (mm)	D (mm)	Vol.
BLR-101J	3/8	200	132	89	1.0L
BLR-102J	3/8	258	181	127	2.9L
BLR-103J	3/8	290	203	127	3.2L
BLR-104J	1/2	348	257	165	6.2L
BLR-105J	5/8	414	320	165	7.5L
BLR-106J	3/4	600	495	165	11.2L
BLR-107J	7/8	700	585	165	13.2L

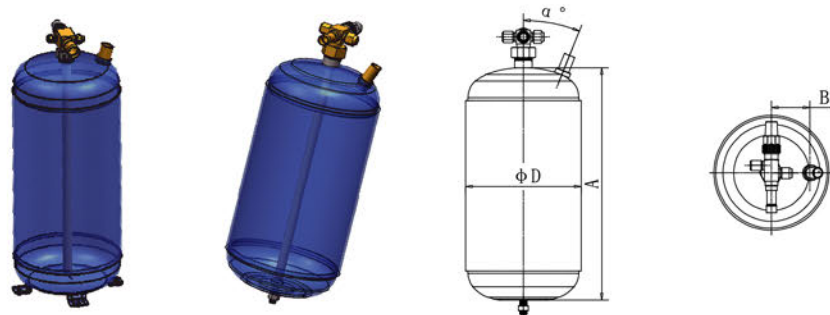
BLR Vertical Receiver

Type	ODF	A (mm)	B (mm)	D (mm)	α°	Vol.
BLR - 133	3/8	170	35	102	18.2°	1.1L
BLR - 166	3/8	192	40	114	22.3°	1.6L
BLR - 233	3/8	185	42	127	20°	2L
BLR - 333	3/8	293	42	127	20°	3L
BLR - 433	3/8	238	55	165	21°	4L
BLR - 644	1/2	332	55	165	21°	6L
BLR - 844	1/2	432	55	165	21°	8L
BLR - 855	5/8	432	55	165	21°	8L
BLR - 1055	5/8	322	75	219	17°	10.0L
BLR - 1255	5/8	380	75	219	17°	12L
BLR - 1455	5/8	435	75	219	17°	14L
BLR - 1466	3/4	435	75	219	17°	14L
BLR - 1677	7/8	492	75	219	17°	16L
BLR - 1877	7/8	549	75	219	17°	18L
BLR - 2077	7/8	606	75	219	17°	20L

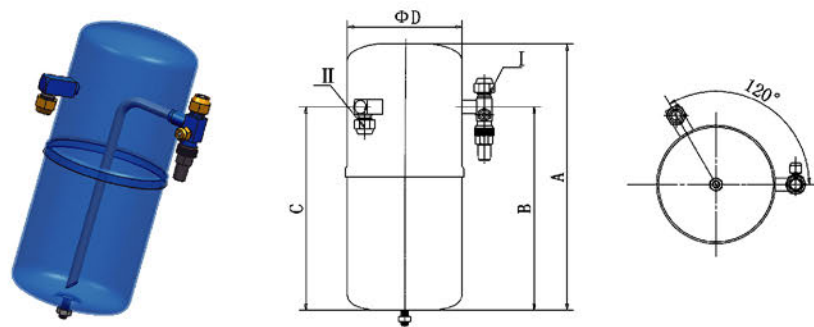

Type	SAE	A (mm)	B (mm)	C (mm)	D (mm)	Vol.
BLR - 101	1/4 3/8	218	136	136	89	1.1L
BLR - 102	3/8 3/8	245	160	160	130	2.9L
BLR - 103	3/8 3/8	298	208	208	130	3.5L
BLR - 104	1/2 1/2	360	275	275	152	6.0L
BLR - 105	5/8 5/8	412	275	322	180	9.6L