

- △ Storage temperature:  $-29^{\circ}\text{C} \sim 82^{\circ}\text{C}$  △ Ambient temperature:  $-20^{\circ}\text{C} \sim 71^{\circ}\text{C}$
- △ Media temperature range:  $-20^{\circ}\text{C} \sim 93^{\circ}\text{C}$  △ Max. static pressure: 10bar
- △ Pressure connection: 1/4" SAE(7/16" -20UNF)G、1/4"NPT for optional)
- △ Max. pressure difference: 5bar △ Set point repeatability tolerance:  $\pm 1\%$
- △ Output: one SPDT dry contact output, one or two for optional factory set one N/O.
- △ Switch: 10A(max)、125/250VAC
- △ Electrical connection: DIN 43650 /direct connect ( $105^{\circ}\text{C}$  resistance burning  $2 \times 0.75$  or  $3 \times 0.75\text{mm}$  for optional)

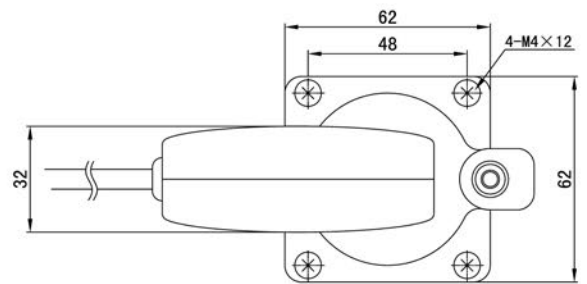

Model	Set point	Hysteresis
FSF0002	2kPa	0.8kPa
FSF0003	3kPa	1kPa
FSF0004	4kPa	1.2kPa
FSF0005	5kPa	1.5kPa
FSF0006	6kPa	1.5kPa
FSF0008	8kPa	1.7kPa
FSF0010	10kPa	2kPa
FSF0011	11kPa	2.3kPa
FSF0012	12kPa	2.5kPa
FSF0013	13kPa	2.5kPa
FSF0014	14kPa	3kPa
FSF0017	17kPa	4kPa
FSF0020	20kPa	5kPa
FSF0025	25kPa	6kPa
FSF0030	30kPa	7kPa
FSF0035	35kPa	8kPa
FSF0040	40kPa	8kPa

### DIN 43650connector

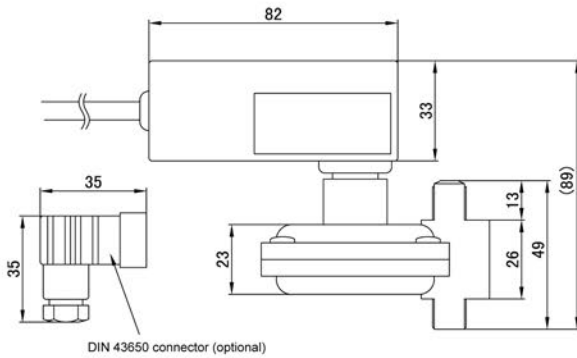
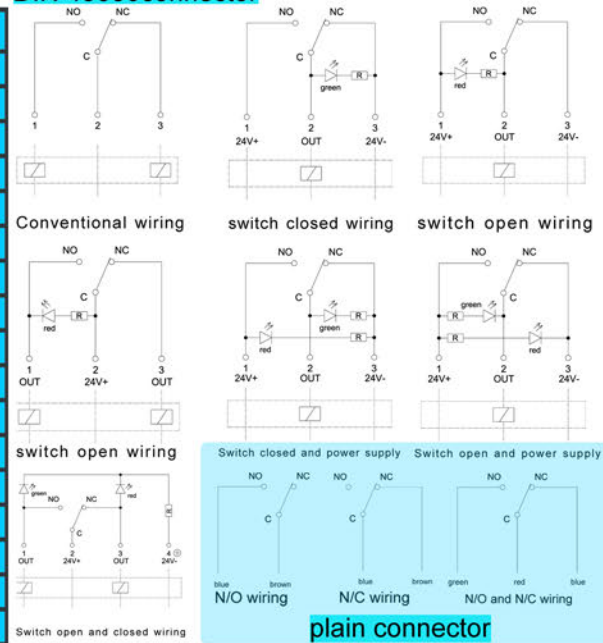

### differential pressure flow switch installation

