

□ Introduction

Globe valve can be used in commercial refrigeration system, civil and industrial air conditioning equipments. It was designed with piston close and seal, so that this valve can be installed on anywhere of refrigerant flow position of the system.

□ Feature

- ◆ Valve handle with special designed, can be shut-off without using any tools.
- ◆ Extended copper connection makes installation easier. we don't need to open the valve during welding.
- ◆ Can be used for all fluorinated refrigerants.
- ◆ Valve plate of polyamide nylon to give complete shutoff with minimum torque

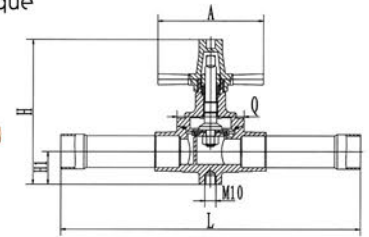
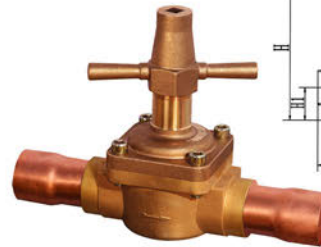
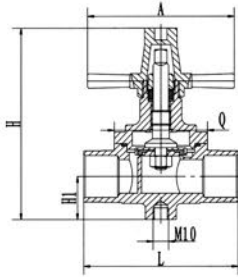

□ Standardized Valve

TYPE	ODF Connection		H		H1		L		Q		A	
	Inch	mm	Inch	mm	Inch	mm	Inch	mm	Inch	mm	Inch	mm
6512/7	7/8	22.4	5.4	136	1.1	28.5	3.9	100	2.4	60	3.7	94
6512/9	1-1/8	28.8	5.4	136	1.1	28.5	3.9	100	2.4	60	3.7	94
6512/11	1-3/8	35.0	6.5	166	1.3	34	4.6	118	2.8	68	5.0	126
6512/13	1-5/8	42.0	7.8	199	1.5	37	5.6	141	3.5	88	5.4	138
6512/17	2-1/8	54.0	8.5	215	1.7	42.5	6.8	173	4.1	104	5.4	138

□ Valve with extend longer tube for ODF connection

6542/7	7/8	22.4	5.4	136	1.1	28.5	6.7	170	2.4	60	3.7	94
6542/9	1-1/8	28.8	5.4	136	1.1	28.5	7.9	201	2.4	60	3.7	94
6542/11	1-3/8	35.0	6.5	166	1.3	34	9.1	232	2.8	68	5.0	126
6542/13	1-5/8	42.0	7.8	199	1.5	37	10.1	256	3.5	88	5.4	138
6542/17	2-1/8	54.0	8.5	215	1.7	42.5	11.2	285	4.1	104	5.4	138

Refrigerant	CFC、HCFC、HFC
Media Temperature	-60°C→160°C
Ambient Temperature	-50°C→80°C
Max. Working Pressure	3.0Mpa
Max. Test Pressure	4.2Mpa