

Gasketed plate-and-frame heat exchangers provide efficient heat transfer in compact equipment with a small footprint. The units have a flexible design and are easy to service and maintain. The product range is extremely wide and is used in duties for heating, cooling, heat recovery, evaporation and condensation in industries ranging from HVAC, refrigeration, engine cooling, dairy and food to heavier processes like chemical processing, oil production and power generation.

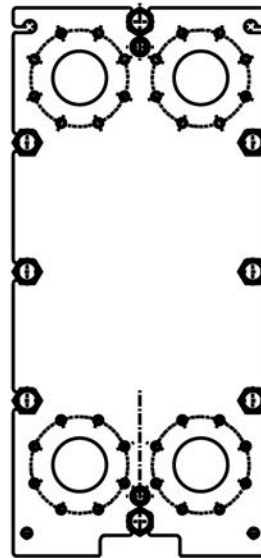

Front

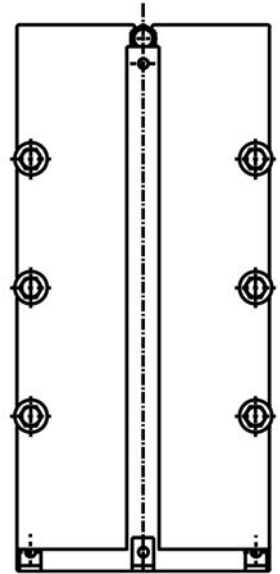

Back

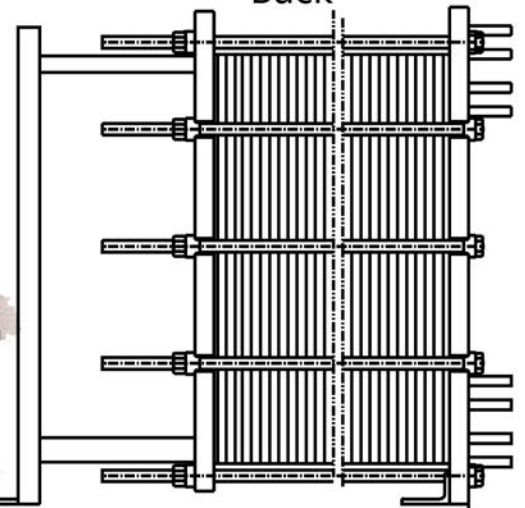
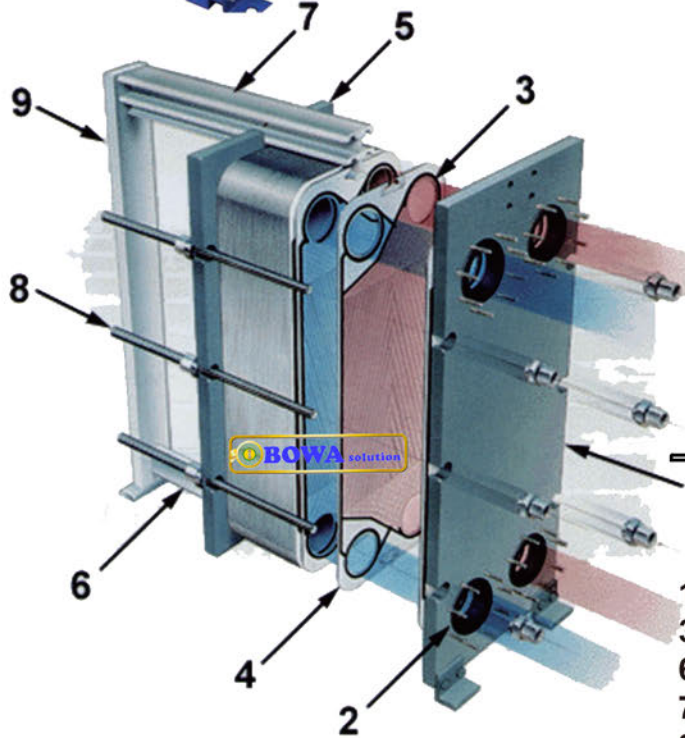

Side

- 1. Front frame
- 2. Connection Port
- 3. Gasket
- 4. Plate
- 5. Rear frame
- 6. Bottom guiding bar
- 7. Top guiding bar
- 8. Tightening bar
- 9. Column

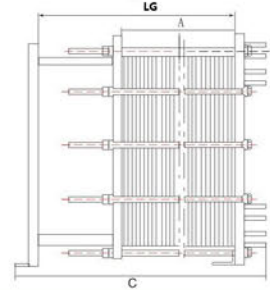
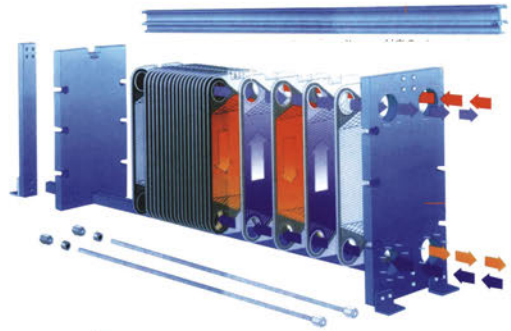

Type	A(MM)	L(MM)	H(MM)	D(MM)	E(MM)	LG(MM)	Connection size	Max number of plates	Max flow rate
M30	N(2.0+X)	180	480	60	357	1000	32	80	15
MH60B	N(2.0+X)	320	930	140	640	1200	60	250	36
MH60H	N(3.0+X)	320	930	140	640	1200	60	203	36
MH100B	N(2.55+X)	470	1069	225	719	1600	100	278	140
MH100H	N(3.95+X)	470	1069	225	719	1600	100	180	140
MH150B	N(2.5+X)	610	1815	298	1294	3000	150	600	360
MH150H	N(3.95+X)	610	1815	298	1294	3000	150	600	360
MH200H	N(4.0+X)	780	2150	355	1480	3000	200	398	600
MH250H	N(3.5+X)	1100	2415	560	1460	2340	250	300	795
MH350H	N(3.5+X)	1100	2155	560	1720	3600	350	350	997

## Plate

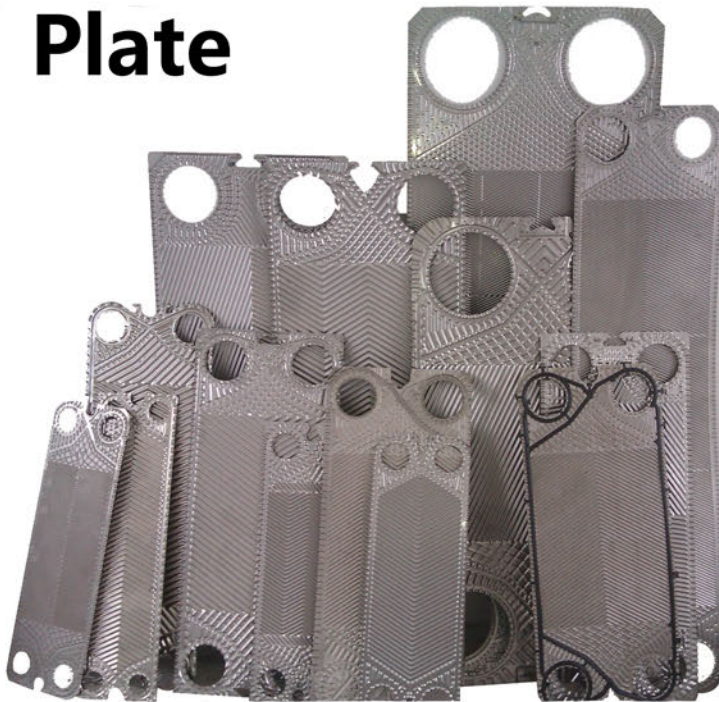

**X small angle**



**D Big Angle**

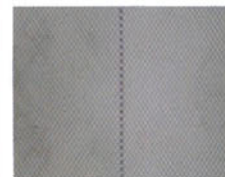

**X + X = X**

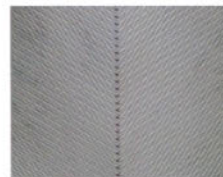

**X + D = H**



**D + D = D**



**Plate+Gasket**

### Material of the plate

### Applicable to fluids

Stainless steel (SUS304.316 etc)

Clean water, river water, edible oil, mineral oil

Stainless steel (Ti,tii-Pd)

Sea water, salty water, salinuous compounds

20Cr, 18Ni, SMO

Low concentration sulfate acid, water solution of salinuous matter, inorganic water solution

Nickel

High temperature and high concentration caustic soda

Hastelloy

High concentration sulfate acid, chloride acid, phosphate acid



## Gasket Type

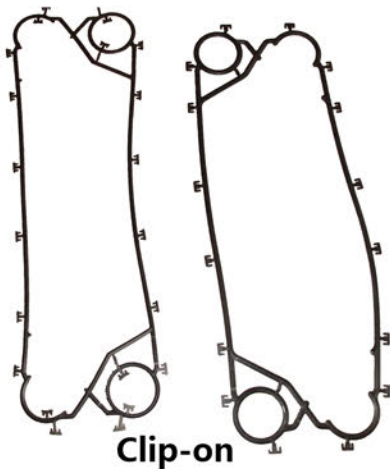

Clip-on



Socket



Glue

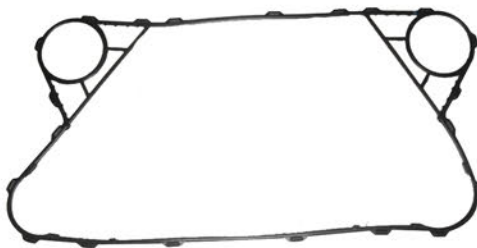

Stud

Material of gasket	Applicable temperature	Applicable to fluids
NBR	-15 ~ +135	Water, sea water, mineral oil, salinuous water
EPDM	-25 ~ +180	Hot water, steam, acid, alkali
F26	-55 ~ +230	Acid, alkali, fluids
FTP	0 ~ +160	High concentration acid, alkali, high temperature oil, steam

## Connection Port type and size range

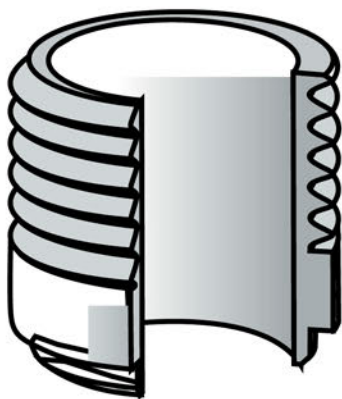

Straight male thread

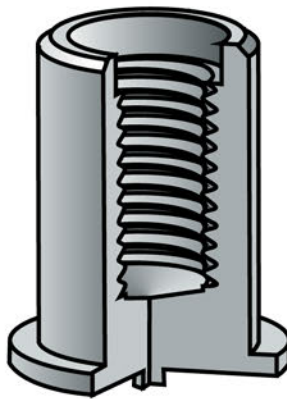

Straight female thread

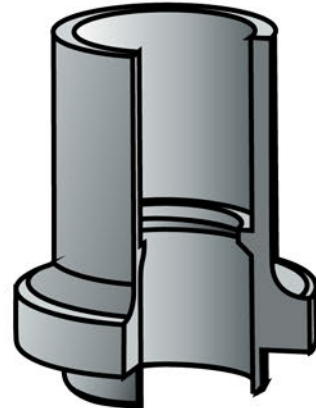

Solder

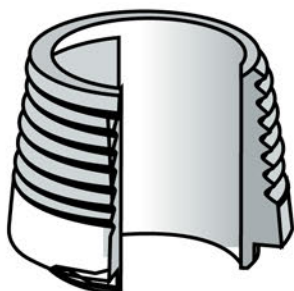

Taper male thread

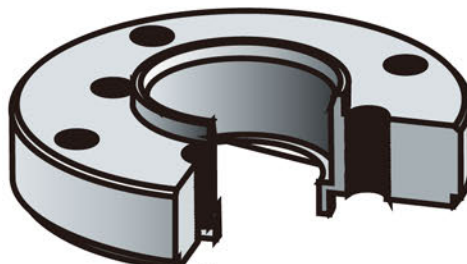

Flange

Connector type	Soldering material
Copper	Min. 5 % Ag
Steel	Silver-flo 55 + Easy-flow flux